



Legislation and Communications Committee

Construction Outreach: Updates and Insight

Item 6a

March 10, 2025

Report on Construction Outreach

Subject

Community outreach and engagement

Purpose

To demonstrate how Metropolitan's Community Relations Team proactively engages with communities

Legislation & Communications Committee

Report on Construction Outreach



Report on Construction Outreach

Recent Outreach Projects

- Allen-McColloch Pipeline PCCP 2024 Urgent Relining
- Compton Lateral
- Etiwanda Pipeline North
- F.E. Weymouth Water Treatment Plant Bonita Avenue Railroad Urgent Track Replacement
- Live Oak Reservoir Pipelines Cathodic Protection
- Perris Valley Pipeline Interstate 215 Crossing
- Rialto Pipeline Rehabilitation
- San Diego Canal
- Santa Monica Feeder Cathodic Protection
- Second Lower Feeder Reach 3A & 3B
- Sepulveda Feeder Urgent Relining

Early Collaboration is Key

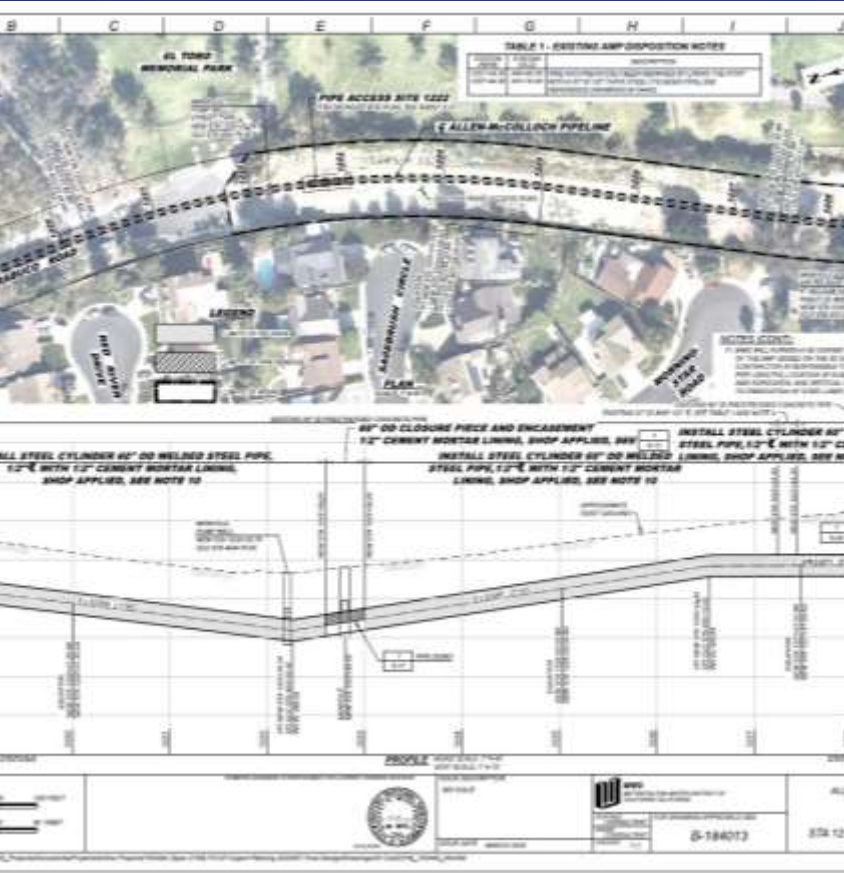

URGENT PIPELINE RELINING PROJECT COMING TO YOUR AREA

JUNE 2024 - JANUARY 2025

The Allen-McColloch Pipeline (AMP) is a key component of Metropolitan's regional water system, spanning 26 miles to supply treated drinking water to the Municipal Water District of Orange County and its retail agencies. Constructed in the 1970s, portions of the prestressed concrete cylinder pipe need to be relined to ensure future water reliability.

In a recent inspection, Metropolitan identified distressed segments of the pipeline that require urgent repairs. This project will rehabilitate approximately 4,500 feet of pipeline.

WHAT TO EXPECT DURING CONSTRUCTION

- Construction began in June 2024 and continues through January 2025
- 24-hour work may be necessary
- You may hear noise due to construction, excavation, ventilation and equipment
- You may notice additional construction vehicle traffic in the area
- Temporary traffic delays and parking restrictions may occur



Oct 11, 2024 at 10:
21941 Sage
Lake Forest
Unit

Proactive Outreach to Communities



Thank you for your support and patience as we work to rehabilitate this major pipeline and ensure water reliability throughout Southern California.

Gracias por su apoyo y paciencia mientras trabajamos para rehabilitar esta importante tubería y garantizar la confiabilidad del agua en todo el sur de California.



Second Lower Feeder - Etapa 3B Fase 2

Una de las tuberías principales en el sistema de agua regional, el Second Lower Feeder, distribuye agua en una extensión de 39 millas desde la Planta de Tratamiento de Agua Robert B. Diemer en Yorba Linda hasta el Reservorio de Palos Verdes en Rolling Hills Estates. Construida en 1967, la antigua tubería cilíndrica de concreto pretensado necesita ser revestida con acero para asegurar su integridad futura. El revestimiento de la tubería en el Second Lower Feeder comenzó en octubre de 2017 y se espera que se lleve a cabo en fases durante los próximos 8-10 años.

El Proyecto de Revestimiento del Second Lower Feeder 3B rehabilitará aproximadamente 4 millas de tubería en las ciudades de Los Angeles y Torrance. La construcción comenzó en octubre de 2024 y se espera que continúe hasta junio de 2025.

Qué esperar durante la construcción

- Ruido de la actividad de construcción
- Retrasos temporarios en el tránsito, restricciones de carriles y estacionamiento
- Puede ser necesario trabajar las 24 horas

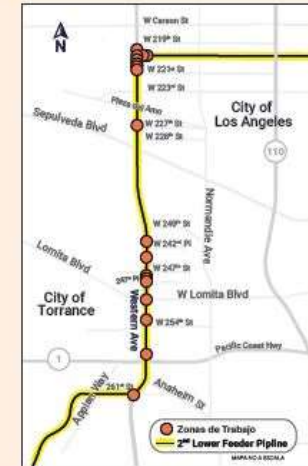

Preguntas frecuentes

¿Por qué necesitan trabajar las 24 horas del día, los 7 días de la semana?
Es necesario trabajar las 24 horas para completar el proyecto de manera eficiente y oportuna. Nuestro objetivo es reanudar las condiciones normales de operación para que podamos garantizar un suministro confiable de agua a nuestras agencias miembros.

¿Afectará este proyecto mi servicio de agua?
No. El agua seguirá siendo entregada por su proveedor local de servicios de agua sin interrupciones en el servicio.

¿Voy a escuchar el ruido de la construcción toda la noche?
La mayoría, si no todo, del trabajo realizado por la noche ocurrirá bajo tierra dentro de la tubería, minimizando el ruido. Es posible que escuche el ruido de los generadores necesarios para operar el sistema de ventilación en la tubería.

¿Cómo afectará esto al tránsito?
El control de tránsito, las restricciones de carriles y los vehículos de construcción adicionales en el área pueden causar retrasos en el tráfico. Por favor tome las precauciones de seguridad apropiadas y permita tiempo adicional para viajar por el área.

¿Preguntas?
CommunityRelations@mwdh2o.com

Sitio Web:
www.mwdh2o.com



Contacto:
Lizeth Martínez (626) 827-0614 Ivonne Castillo (213) 217-8809

Sobre Nosotros
La misión de Metropolitan Water District of Southern California es proveer a su área de servicio con suministros adecuados y confiables de agua de alta calidad, para satisfacer las necesidades presentes y futuras de una manera ambientalmente y económicamente responsable.



Door-to-Door Outreach: Ensuring Accessibility



SEPULVEDA FEEDER URGENT RELINING PROJECT

JANUARY 2024

MARCH - APRIL 2024

The Metropolitan Water District of Southern California will be working on an important relining project to a major water pipeline in your community as a result of a recent inspection conducted of the Sepulveda Feeder. The Sepulveda Feeder delivers treated drinking water from the Joseph Jensen Water Treatment Plant of Granada Hills to an interconnection with the Second Lower Feeder in Torrance, and services the cities of Los Angeles, Santa Monica, and Torrance and the West Basin Municipal Water District.

The urgent project is necessary to ensure Metropolitan's regional water distribution system continues to deliver a reliable water supply to our 26 member agencies that serve 19 million customers across Southern California.

WHAT TO EXPECT

- Construction is scheduled to occur beginning March 15, 2024 and continue through April 2024.
- 24-hour work may be necessary
- You may hear noise due to construction, excavation, ventilation and equipment
- Expect temporary detours, traffic delays lane and parking restrictions
- Your water supply will not be affected
- Additional notification will be provided as needed



BE INFORMED, BE INVOLVED

www.mwdh2o.com



@mwdh2o

FOR MORE INFORMATION:
CommunityRelations@mwdh2o.com

Laura Marlowe
(818) 421-0614

THANK YOU FOR SUPPORT AND PATIENCE

AS WE WORK TO REHABILITATE THIS MAJOR PIPELINE AND ENSURE WATER RELIABILITY THROUGHOUT SOUTHERN CALIFORNIA.

Expanding Our Reach Through Social Media



Metropolitan Water District of Southern California ✓
Sr Public Affairs Representative Ivonne Castillo • 1 day ago • Edited

Hi Neighbors,

🚧 Construction Notice – Street Closures 🚧

The Metropolitan Water District of Southern California will be restoring the asphalt railroad crossing at Bonita Street and Wheeler Avenue. This project is essential for the delivery of supplies to Metropolitan's F.E. Weymouth Treatment Plant, which provides clean and safe drinking water to our region. Construction is scheduled for August 1-3, 2024, between 7 a.m. and 7 p.m. This will require street closures and detours. See map below.

If you have any questions, please email us at communityrelations@mwdh2o.com or visit our Projects in Your Community webpage at <https://www.mwdh2o.com/projects-in-your-community/>

Posted to Subscribers of Metropolitan Water District of Southern California in 6 neighborhoods

👍 2 🗨️ 1 · 268 Impressions

Visible and Informative: On-Site Banners

The Metropolitan Water District
of Southern California



Urgent Water Infrastructure Project

Construction dates: June 2024 – February 2025



THE METROPOLITAN WATER DISTRICT
OF SOUTHERN CALIFORNIA

For More Information:
213-217-5776
CommunityRelations@mwdh2o.com



Listening, Responding and Building Trust



