



# Advancing Resilience Through Distributed Stormwater Capture & Conservation

## ARLA

ONEWATER  
— ECON —



waternow  
alliance  
water leaders. resilient solutions.



craftwater™  
engineering, inc.

The Nature  
Conservancy 

One Water and Adaptation Committee  
May 12, 2025  
Item 6a

# **Accelerate Resilience L.A. (ARLA) activates communities, organizations and governments to expedite climate resilience.**

**Grantmaking | Research | Multi-Agency Collaboration | Technology**

# Today's Presentation

## 1. Present Study Findings:

- Enhanced conservation is a scalable source of water supply
- Conservation co-benefits create co-funding opportunities

## 2. Share Implementation Opportunity:

- Potential Pilot Program with Los Angeles County Department of Public Works

*“Reliability means meeting all of the region’s water demands through a combination of Metropolitan supplies, local supplies, and **increased conservation.**”*

- IRP Needs Assessment, 2022

# ROADMAP

Implement Enhanced Multi-benefit  
Stormwater Capture Incentives

UPDATE INCENTIVE PROGRAM  
OFFERINGS

1

2

APPROPRIATELY MONETIZE  
THE VALUE OF  
CONSERVATION

IDENTIFY OPPORTUNITY  
AREAS & PRIORITY BMPs

3

4

SET AN OUTDOOR  
CONSERVATION TARGET

IDENTIFY AND CALCULATE  
CO-BENEFITS' VALUE

5

6

IDENTIFY FUNDING &  
SPENDING TO ACHIEVE TARGET

PRIORITIZE EQUITY  
OUTCOMES

7

8

ADOPT PROGRAM ADMIN  
STRATEGY

# Roadmap to Enhanced Incentive Strategy

## 1. Update Incentive Program Offerings

## 2. Appropriately Monetize Value of Conservation

## 3. Identify Opportunities Areas and Priority BMPs

## 4. Set an Outdoor Conservation Target

## 5. Identify and Calculate the Value of Co-benefits

## 6. Identify Funding and Spending Needed to Achieve Target

## 7. Prioritize Equity Outcomes

## 8. Adopt an Appropriate Program Administration Strategy

# The Roadmap Supports MWD's CAMP4W



- **Contributes to all CAMP4W themes**
- **Informs and helps achieve CAMP4W time-bound targets** to close supply gaps
- **Provides a methodology to evaluate environmental co-benefits** for CAMP4W
- **Offers creative funding strategies** to evolve MWD's business model
- **Proposes a cooperative funding model** to deepen MWD's regional partnerships
- **Develops an equity framework** to ensure conservation programs benefit those most in need.
- **Demonstrates how MWD can support workforce development** by connecting training programs to job pipelines

# Study Approach

- Modeled stormwater capture & landscape transformation opportunities across property types
- Quantified and monetized the co-benefits of modeled BMPs
- Evaluated multi-payor co-funding models based on benefits



Landscape Transformation



Above Ground Cistern



Engineered Bioretention

# Enhance Incentive Program to Unlock New Opportunities

Shifting from Turf Conversion to Landscape Transformation Increases Water Supply and Other Benefits

## Incentivize:

- **Landscape Transformation**
- **Enhanced bioretention BMPs** for CII properties
- **Cisterns** sized to meet remaining irrigation needs and provide protection against wildfire damages

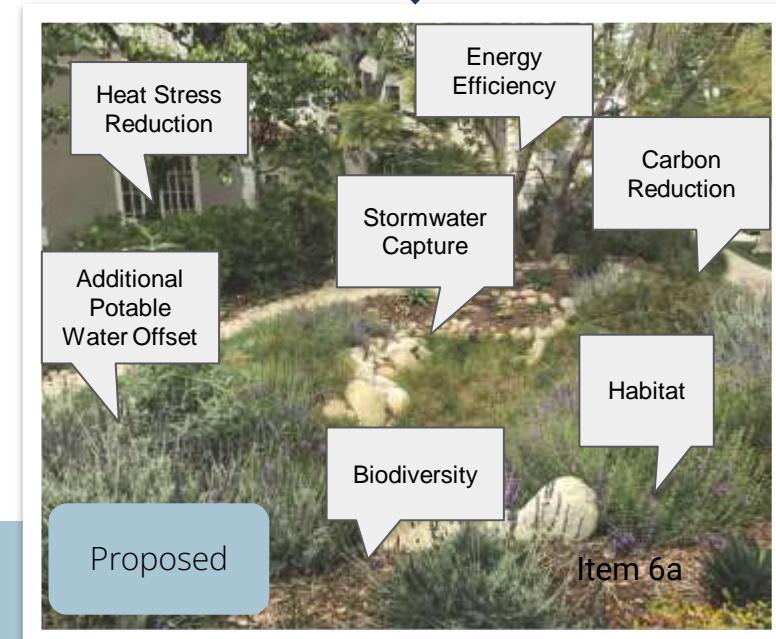

# Multiple Benefits Leads to Multiple Partners

Partnerships increase access to water supply and potential co-funders for incentive programs

## Multiple Benefits

- Potable water offset
- Stormwater capture\*
- Fire risk reduction
- Carbon reduction
- Air quality improvement
- Community uplift
- Habitat and biodiversity
- Energy savings
- Heat stress reduction
- Green Jobs



## Multiple Funders

- Flood Control District
- Municipal stormwater agencies
- State/federal agencies
- Municipal sustainability programs
- Job Training Programs
- Electric Utilities
- Retail Water Providers
- Corporations
- Customers

# Example Scenario: Single-Family Residential & CII Costs

Contribution source	Ratio	Amount
Los Angeles County	40%	\$1,500,000
Metropolitan Water District	40%	\$1,500,000
Retail Water agencies	5%	\$187,000
Customers	5%	\$187,000
Local Govt/grants/other	10%	\$375,000
<b>Total</b>	<b>100%</b>	<b>\$3,750,000</b>

- Rebates to nearly 200 homes and several CII / Large Landscape properties
- 28 AF potable water offset
- Approximately 196,000 square feet of turf transformed
- 52 AF stormwater captured during storm events

# Example Scenario: Single-Family Residential & CII Benefits

- 45% Residential Landscape Transformation with 10% install cisterns
- 30% budget on CII/ large landscape, bioretention for 85<sup>th</sup> percentile storm
- 15% program admin
- Avg. Cost (MWD share) - **\$1,844 AF/year**

30-Year Present Value Benefits

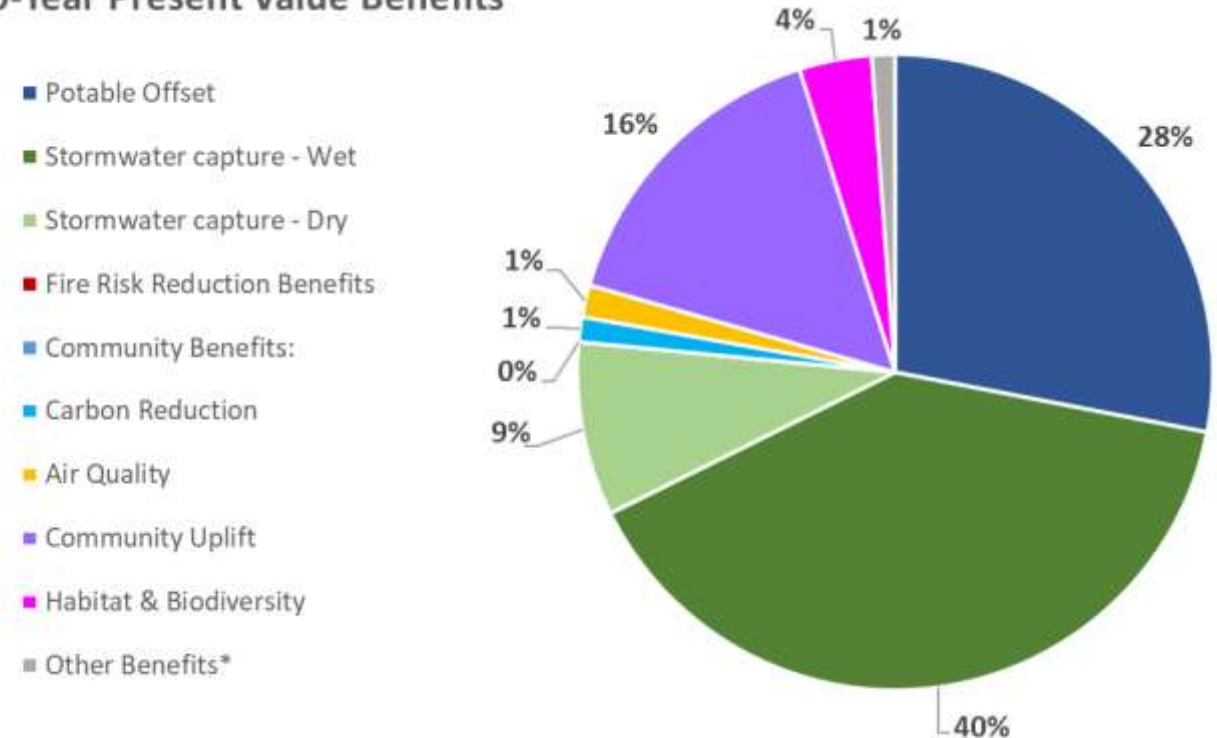

# Opportunity: Potential LA County / MWD Pilot Program

- Potential interest from LA County DPW to leverage Safe, Clean Water Program funds
- Pilot: Direct install and/or hybrid rebate for landscape transformation, cisterns & bioretention on Single-Family and CII properties
  - \$1.5M MWD Contribution
  - \$1.5M Potential Match from SCWP
  - Additional Opportunities (State, local agencies)



# Pilot Program Opportunity

## Goals

- Create pathway to close water supply gaps and advance CAMP4W Targets
- Deepen regional partnerships and leverage outside funding
- Increase Disadvantaged Community participation in conservation programs
- Advance workforce development

## Desired Outcomes

- Retrofit up to 200 homes and a few businesses
- Monitor and study co-benefits
- Test portfolio funding model
- Position MWD to lead regional partnerships and oversee outcomes based contracts for: direct install, workforce development, etc.

# Thank You

Please visit  
[acceleratela.org/incentives](https://acceleratela.org/incentives) for  
the full report and  
recommendations

Contact ARLA for questions:

- [dbloome@acceleratela.org](mailto:dbloome@acceleratela.org)

