



Subcommittee on Long-Term Regional Planning  
Processes and Business Modeling

# Draft Climate Adaptation Master Plan for Water Policy Framework

Item 3c

January 29, 2025

Item 3c

CAMP4W  
Draft Policy  
Framework  
Discussion

### Subject

Discuss the development of a Climate Adaptation Policy Framework for Board Approval in April 2025.

### Purpose

Seek input from the CAMP4W Task Force on the Climate Adaptation Policy Framework aimed to systemically align Metropolitan with CAMP4W priorities.

### Next Steps

In February, staff will include the Climate Adaptation Policy Framework as a component of the Draft CAMP4W Implementation Strategy. Member agency comments on the Policy Framework/Draft Working Memorandum #10 are requested by Monday, February 10, 2025.

# CAMP4W Task Force Charter

## CAMP4W Task Force

Joint Task Force of Board Members and Member Agencies has been chartered to produce a regional plan (CAMP4W) that will develop and establish a master plan that includes:

- Climate and Growth Scenarios
- Time-bound Targets
- Framework for Climate Decision-Making and Reporting
- **Policies, Initiatives, and Partnerships**
- Business Models and Funding Strategies



# CAMP4W is Iterative and Adaptive



- Adaptive management approach to systemically address the impacts of climate change
- Stepwise approach to ensure alignment and integration of climate, resource and financial planning
- Continuous engagement with Board, member agencies, and interested parties
- Monitoring and reporting on real-world conditions, updated climate projections, and implementation progress informs decision-making
- This discussion focuses on overall policy direction for developing and integrating climate adaptation across the agency

# CAMP4W is Iterative and Adaptive

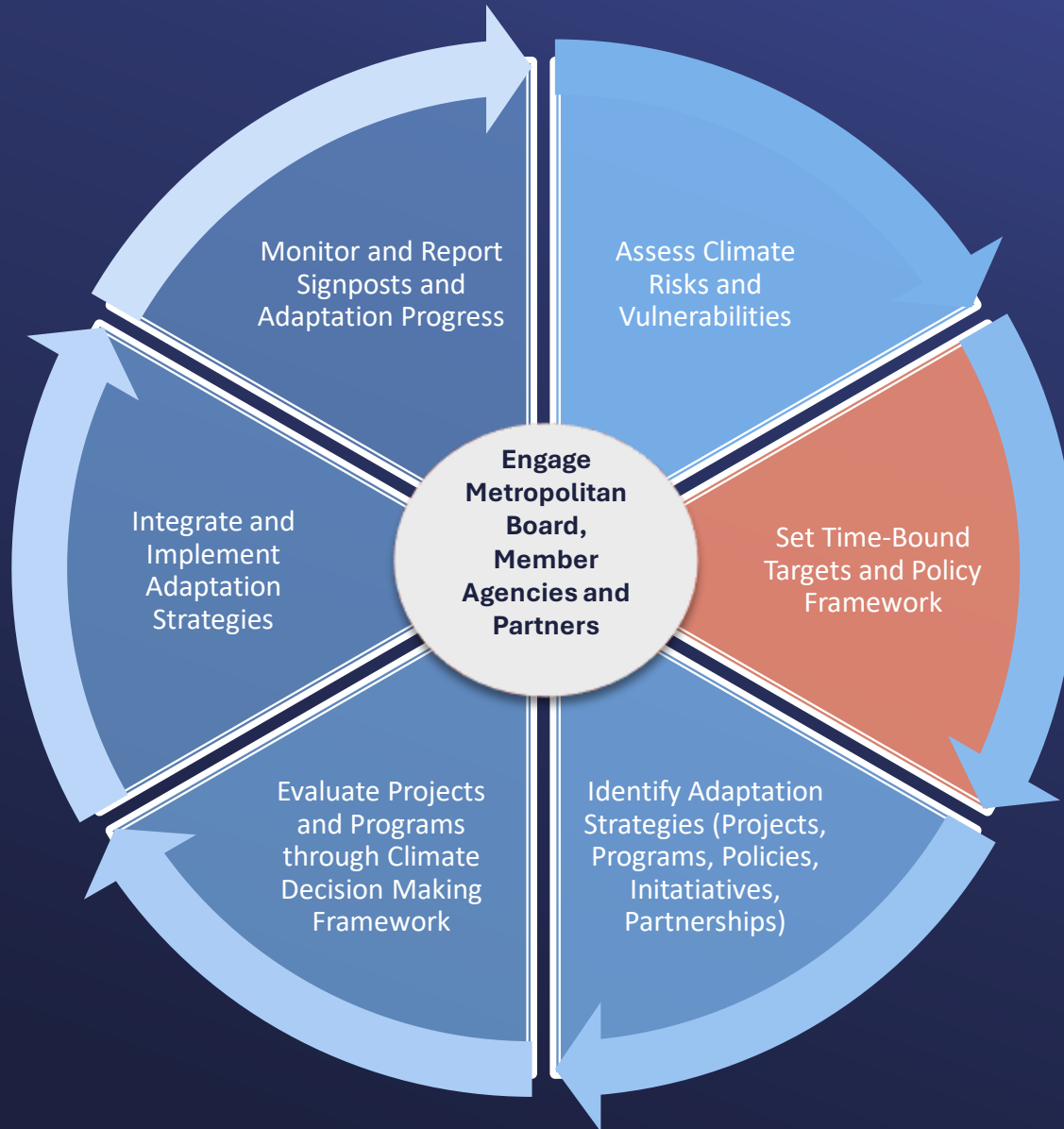

- Adaptive management approach to systemically address the impacts of climate change
- Stepwise approach to ensure alignment and integration of climate, resource and financial planning
- Continuous engagement with Board, member agencies, and interested parties
- Monitoring and reporting on real-world conditions, updated climate projections, and implementation progress informs decision-making
- **This discussion focuses on overall policy direction for developing and integrating climate adaptation across the agency**

# A Policy Framework to systemically integrate Climate Adaptation

## Policy Framework Objectives

1. Systemically integrate climate adaptation to increase climate preparedness and internal awareness and improve climate hazard response
2. Update existing and set new policies to strengthen the role of adaptive management and climate adaptation in Metropolitan's initiatives and decision making
3. Underscore the value of the Metropolitan Member Agency cooperative and other partnerships in achieving regional climate resilience





## A Policy Framework to systemically integrate Climate Adaptation

### Existing Climate-Related Policies

1. Board Legislative Priorities reviewed annually to address emerging and applicable issues related to climate action and adaptation
2. Existing Board Adopted Policy Principles include limited climate-specific policies:
  - 2022 Bay-Delta Policy Framework addresses climate risks and resilience in Bay-Delta
  - 2016 Policy on incorporating climate adaptation into Watershed Management Plans
  - 2002 Policy on incorporating climate into water resources planning



# Climate Adaptation Policy Framework Structure

## CAMP4W Themes

Reliability	Resilience	Financial Sustainability	Affordability	Equity
-------------	------------	--------------------------	---------------	--------

## Board Policy Objectives (Overarching Direction)

Integrate climate adaptation into water supply reliability	Achieve climate resilience of resources and infrastructure	Account for financial risks associated with climate change	Consider cost impacts of climate adaptation	Include affected communities in climate adaptation
--	--	--	---	--

## Initiatives (Specific Implementation Actions)

Policies, Programs, Actions, Studies, Research, Partnerships etc. to implement Climate Adaptation Policy Objectives
---



# CAMP4W Themes Inform Policy Framework and Initiatives

Themes	Overarching Policy Objectives
Reliability	➤ Metropolitan will consider climate risks and integrate climate adaptation strategies into water supply programs, policies, planning, and operations
Resilience	➤ Metropolitan will integrate climate risk and vulnerability assessments for climate-related hazards including drought, extreme heat and precipitation, sea level rise, flooding, and wildfire using the best available climate science and climate change information into planning, implementation and operations
Financial Sustainability	➤ Metropolitan will reduce short-term and long-term climate-related financial risks through its reserve policy, efforts to increase fixed revenues, active monitoring and managing of financial conditions, and by maintaining flexible financing alternatives
Affordability	➤ Metropolitan will continue to support retail user affordability efforts by pursuing cost-effective investments, new non-rate dependent revenue sources and other financial tools that support our mission to provide regional wholesale water service in the most economically responsible way
Equity	➤ Metropolitan will engage with the diverse communities we serve to listen, communicate transparently, and co-create solutions for greater equity in climate adaptation planning and implementation

# CAMP4W Themes Inform Policy Framework and Initiatives

Themes	Policy Objective
Reliability	<ul style="list-style-type: none"><li>➤ Metropolitan will consider climate risks and integrate climate adaptation strategies into water supply programs, policies, planning, and operations</li></ul>

## Example Initiatives:



Incentives for Member Agencies to increase regional water resilience



Watershed resilience projects to strengthen imported supplies



Programs to actualize benefits from wet weather years

# CAMP4W Themes Inform Policy Framework and Initiatives

Themes	Policy Objective
Resilience	➤ Metropolitan will integrate climate risk and vulnerability assessments for climate-related hazards including drought, extreme heat and precipitation, sea level rise, flooding, and wildfire using the best available climate science and climate change information into planning, implementation and operations

## Example Initiatives:

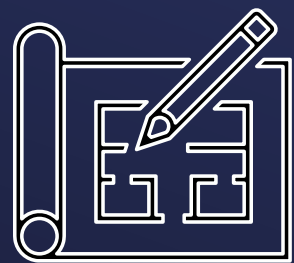

Establish infrastructure performance criteria for resilience



Assess power system vulnerabilities



Review workforce safety measures for climate risks



Update fire management plans for critical facilities

# CAMP4W Themes Inform Policy Framework and Initiatives

Themes	Policy Objective
Financial Sustainability	➤ Metropolitan will reduce short-term and long-term climate-related financial risks through its reserve policy, efforts to increase fixed revenues, active monitoring and managing of financial conditions, and by maintaining flexible financing alternatives

## Example Initiatives:

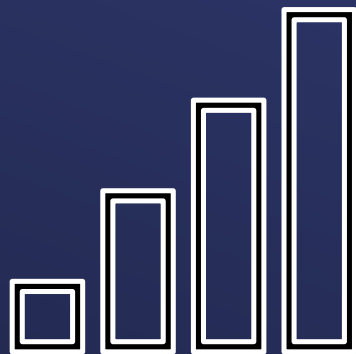

Track financial implications of climate-induced expenses



Consider updates to reserve policy

# CAMP4W Themes Inform Policy Framework and Initiatives

Themes	Policy Objective
Affordability	➤ Metropolitan will continue to support retail user affordability efforts by pursuing cost-effective investments, new non-rate dependent revenue sources and other financial tools that support our mission to provide regional wholesale waters service in the most economically responsible way

## Example Initiatives:



Identify new partnerships, grants and revenue sources for climate adaptation



Enhance water conservation incentives to reduce financial impacts



Work with Member Agencies to identify funds for statewide low-income rate assistance

# CAMP4W Themes Inform Policy Framework and Initiatives

Themes	Policy Objective
Equity	➤ Metropolitan will engage with the diverse communities we serve to listen, communicate transparently, and co-create solutions for greater equity in climate adaptation planning and implementation

## Example Initiatives:



Develop environmental justice and community benefits policy



Develop community engagement standards



Partner with CBOs to advance water efficiency programs



# 2025 Q1 CAMP4W Activities

## ➤ Jan. 29, 2025: CAMP4W Task Force

- Discuss 2024 Annual Report
- Climate Adaptation Policy Framework
- Documents:
  - Draft 2024 Annual Report
  - Final Working Memos #7 and #8
  - Draft Working Memo #10

## ➤ Feb. 26, 2025: CAMP4W Task Force

- Seek Board Input on Draft Master Plan Implementation Strategy
- Provide Final 2024 Annual Report
- Documents:
  - Final 2024 Annual Report
  - Final Working Memo #10
  - Draft Implementation Strategy

## ➤ March 26, 2025: CAMP4W Task Force

- Review Climate Adaptation Master Plan Implementation Strategy
- Documents:
  - Draft Implementation Strategy

## ➤ April 13/14, 2025: FAM and Board

- Seek Board Approval of Climate Adaptation Master Plan Implementation Strategy
- Documents:
  - Final Implementation Strategy

# Integrating Climate Adaptation (Working Memo #7)

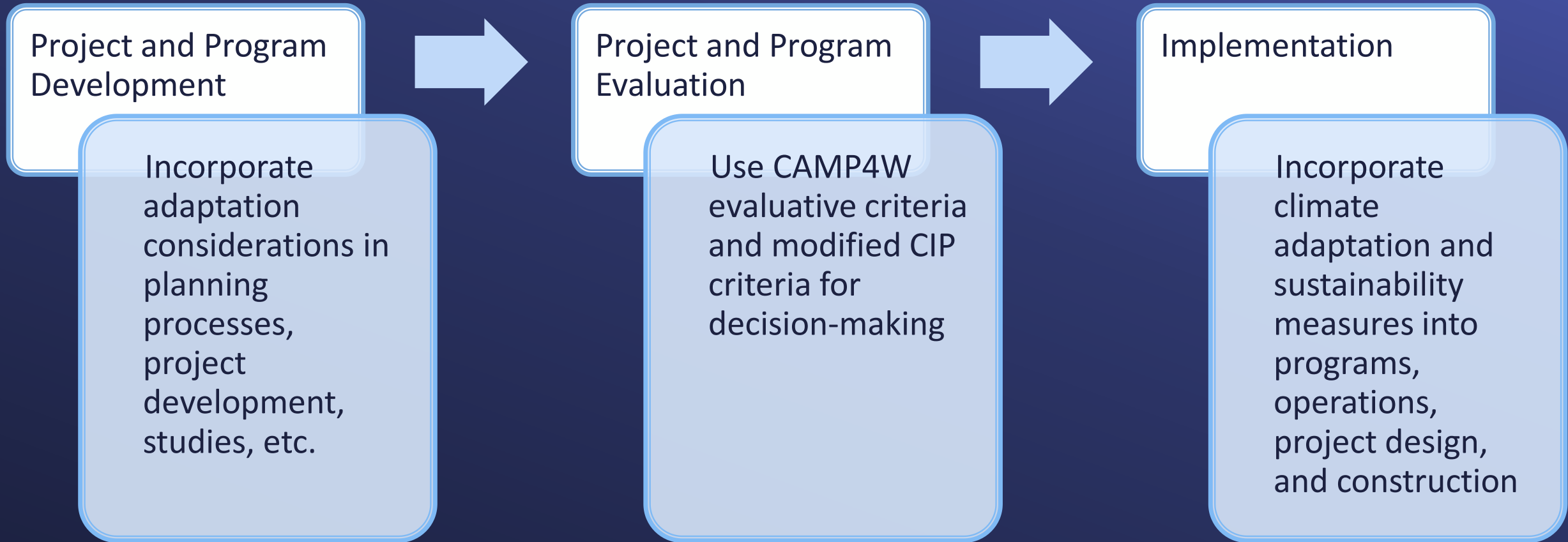

# Working Memo #7

## Integrating Climate Change Adaptation into Metropolitan's Planning Processes



## Specific Actions to Integrate Climate Adaptation

### 1) Planning Phase:

- a. Incorporate CAMP4W priorities, as reflected in the CAMP4W evaluative criteria, in updates to Metropolitan plans, guidelines, standards, and reports.
- b. Add language to Requests for Proposals, if applicable, and project scoping documents to reflect climate adaptation priorities.
- c. Update data sets, assessments, and analyses to reflect real-world conditions (as reported through Signposts) and the best available climate science.

### 2) Evaluation Phase:

- a. Evaluate projects and programs meeting the CAMP4W threshold utilizing CAMP4W evaluative criteria.
- b. Modify CIP evaluative criteria to reflect CAMP4W priorities and utilize for all projects being evaluated.

### 3) Deliberation Phase:

- a. Support Board deliberation at each iteration with best available information.
- b. Prepare CAMP4W briefing sheets for Board actions.

### 4) Implementation Phase:

- a. Develop project and program implementation documents (specifications, provisions, plans, etc.) to advance CAMP4W priorities.

# CAMP4W Implementation Strategy Draft in February 2025

# Climate Adaptation Master Plan for Water

Regional Needs  
Assessment

Climate Risk and  
Vulnerability  
Assessments

Infrastructure  
Studies and  
Assessments

Public & Partners  
Engagement

## Implementation Strategy

Time-Bound  
Targets

Policy Framework

Adaptation  
Strategies

## Climate Decision-Making Framework

Evaluative Criteria

Project/Program  
Assessments

CIP Integration

## Adaptive Management

Signposts

Annual Reports

Five Year Reviews

## Financial Alignment

Business Model  
Refinements

Financial Forecast

Biennial Budget

Affordability  
Strategies

# CAMP4W Implementation Strategy (Draft Feb. 2025)

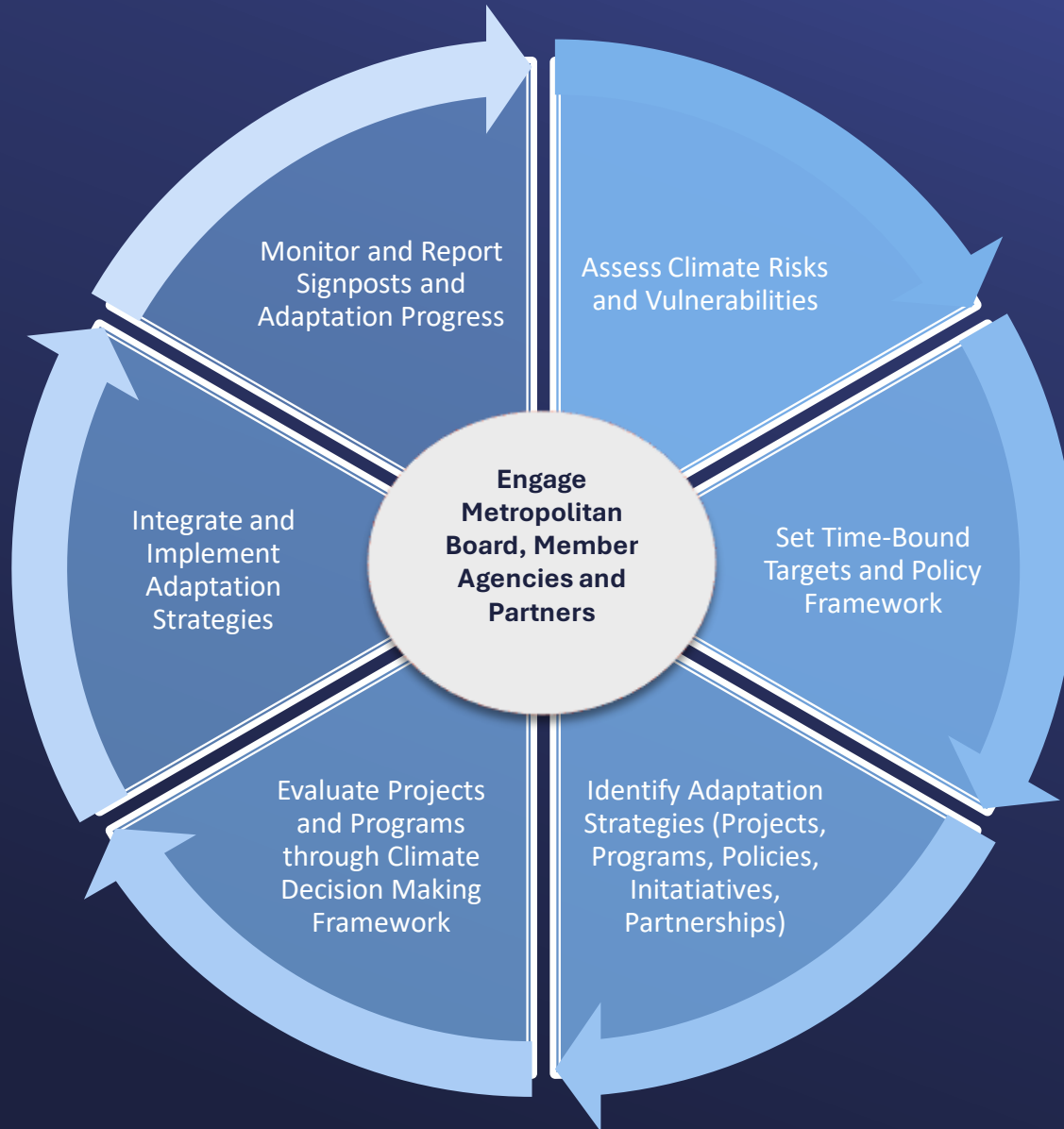

## Working Outline

- I. Purpose and Need
  - a. Problem Statement
  - b. Climate Risks and Vulnerabilities
  - c. Regional Needs Assessment
- II. Time-Bound Targets
  - a. Resource-based and Policy-based
  - b. Near term and Long term
- III. Policy Framework
  - a. Climate Adaptation Policy Objectives
- IV. Adaptation Strategies
  - a. Project and Program Development
  - b. Policies, Initiatives and Partnerships
- V. Climate Decision Making Framework
  - a. Evaluative Criteria and Comprehensive Assessment
- VI. Integration and Implementation Processes
- VII. Adaptive Management/Monitoring and Reporting
- VIII. Public Engagement and Transparency



# CAMP4W Implementation Strategy (Draft Feb. 2025)

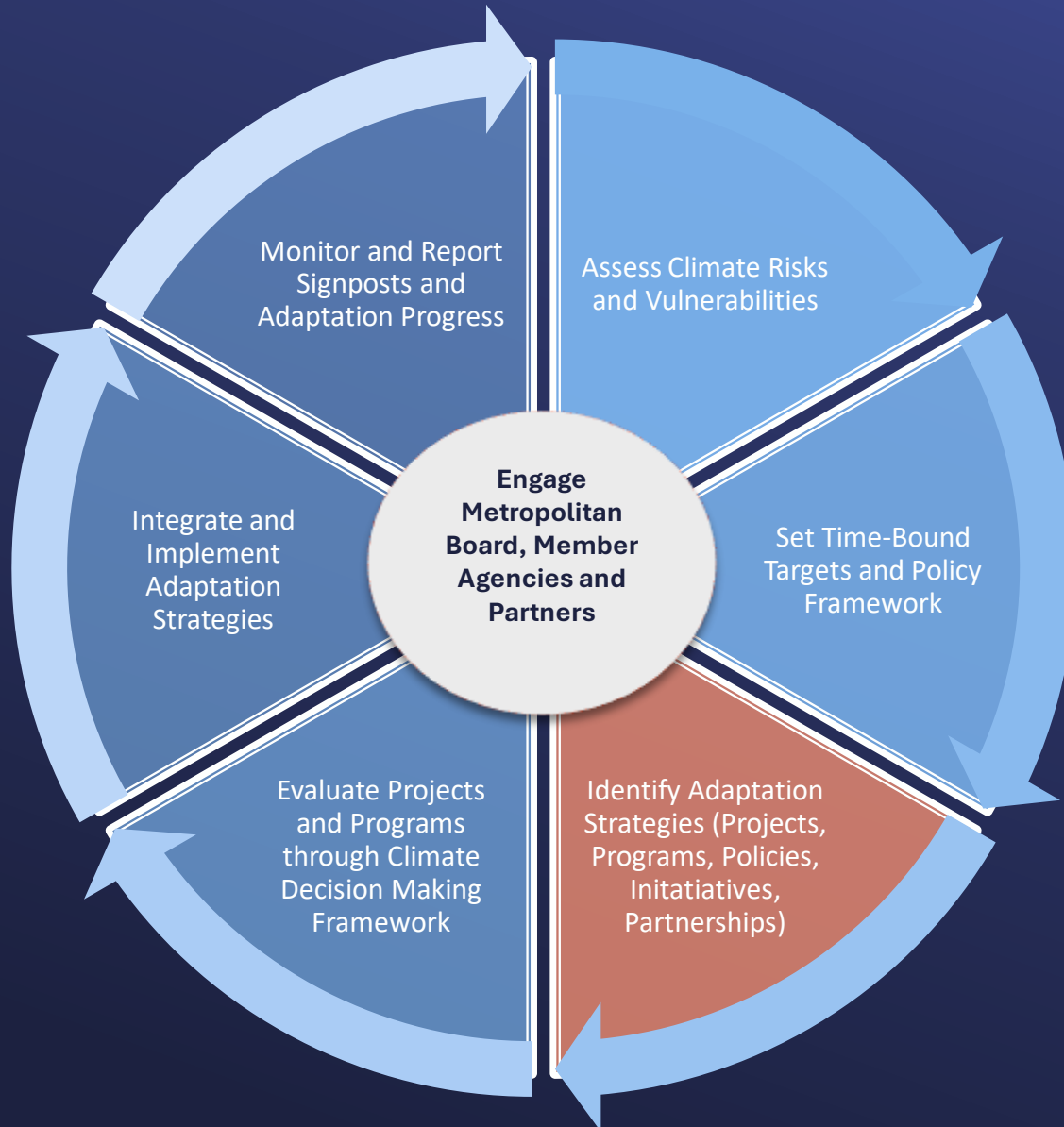

## Working Outline

- I. Purpose and Need
  - a. Problem Statement
  - b. Climate Risks and Vulnerabilities
  - c. Regional Needs Assessment
- II. Time-Bound Targets
  - a. Resource-based and Policy-based
  - b. Near term and Long term
- III. Policy Framework
  - a. Climate Adaptation Policy Objectives
- IV. Adaptation Strategies
  - a. Project and Program Development
  - b. Policies, Initiatives and Partnerships
- V. Climate Decision Making Framework
  - a. Evaluative Criteria and Comprehensive Assessment
- VI. Integration and Implementation Processes
- VII. Adaptive Management/Monitoring and Reporting
- VIII. Public Engagement and Transparency

